

Manifest		Legend	
16 x	WK 091 Diverted Traffic		Local Access Only
7 x	WK 001 Roadworks Ahead		P 010 End
4 x	Local Access Only		P 011 Cautionary Speed 25km/h
4 x	P 080 Slow		P 080 Slow
4 x	WK 094 Road Closed		RUS 014 No Overtaking
3 x	P 010 End		WK 001 Roadworks Ahead
3 x	RUS 014 No Overtaking		WK 072 Slippery Road
3 x	WK 060 Temporary Traffic Signals		WK 074 Soft Verge
2 x	P 011 Cautionary Speed 25km/h		WK 090 Detour
1 x	WK 051 Flagman Ahead		WK 091 Diverted Traffic
1 x	WK 072 Slippery Road		WK 094 Road Closed
1 x	WK 074 Soft Verge		Work Area
1 x	WK 090 Detour		

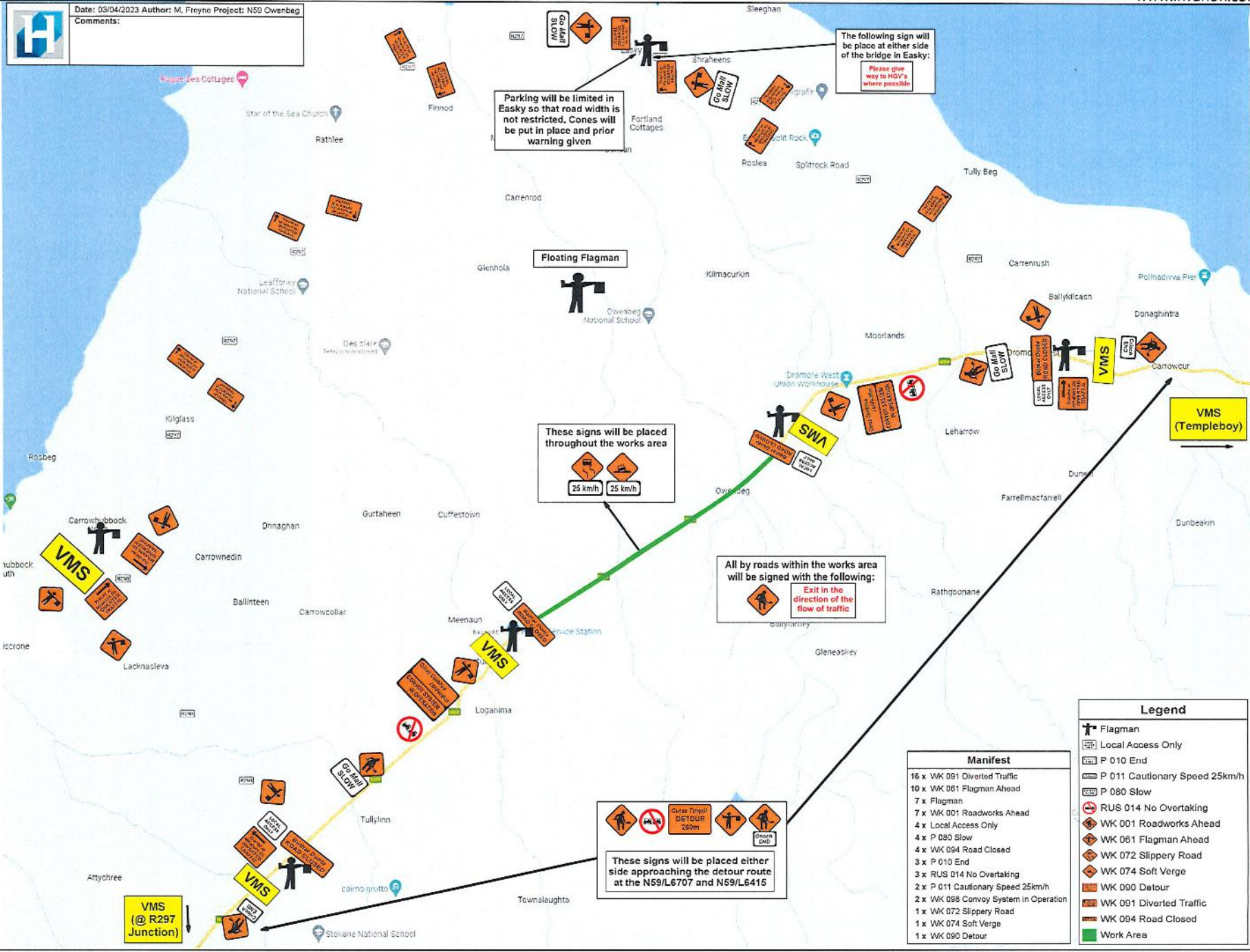

Parking will be limited in Easky so that road width is not restricted. Cones will be put in place and prior warning given

The following sign will be placed at either side of the bridge in Easky:
 Please give way to HGV's where possible

Floating Flagman

These signs will be placed throughout the works area

All by roads within the works area will be signed with the following:
 Exit in the direction of the flow of traffic

These signs will be placed either side approaching the detour route at the N59/L6707 and N59/L6415

Legend	
	Flagman
	Local Access Only
	P 010 End
	P 011 Cautionary Speed 25km/h
	P 080 Slow
	RUS 014 No Overtaking
	WK 001 Roadworks Ahead
	WK 061 Flagman Ahead
	WK 072 Slippery Road
	WK 074 Soft Verge
	WK 090 Detour
	WK 098 Convoy System in Operation
	1 x WK 072 Slippery Road
	1 x WK 074 Soft Verge
	1 x WK 090 Detour

Manifest	
16 x	WK 091 Diverted Traffic
10 x	WK 061 Flagman Ahead
7 x	Flagman
7 x	WK 001 Roadworks Ahead
4 x	Local Access Only
4 x	P 080 Slow
4 x	WK 094 Road Closed
3 x	P 010 End
3 x	RUS 014 No Overtaking
2 x	P 011 Cautionary Speed 25km/h
2 x	WK 098 Convoy System in Operation
1 x	WK 072 Slippery Road
1 x	WK 074 Soft Verge
1 x	WK 090 Detour

VMS (@ R297 Junction)

VMS (Templeboy)